



OPTIM

ALL ROUNDER HAND STEAMER

Compact Hand Steamer
Accessories Included





O2900 Hand Steamer

Congratulations on the purchase of your new Optim All Rounder Hand Steamer. There are many useful features built into your All Rounder Hand Steamer. We recommend that you carefully read this instruction manual for the best results.

Features:

1. Safety Cap
2. Children Lock
3. Small Steam Nozzle
4. Steam Release Switch
5. Flexible Cable
6. Power Indicator

Accessories:

7. Ironing Brush
8. Big Steam Nozzle
9. Steam Hose
10. Windows Brush
11. Funnel
12. Measuring Cup
13. Ironing Brush Towel
14. Bend Nozzle
15. Nylon Brush

Specifications:

Max Power: 1000W

Boiler Capacity: 250ml

Steam Pressure: 3 Bar

Voltage: 220-240V~ 50Hz

Net Weight: 1.4kg

Gross Weight: 2.1kg

Please contact Godfreys Commercial Customer Support on 131 929 to find your local spare parts provider.

Before You Begin

This cleaner must be operated in accordance with these instructions and used only for domestic household cleaning.

This cleaner is not fit to be used as a commercial cleaner hence will void the manufacturer's warranty if used inappropriately.

Please read these instructions thoroughly

This will ensure you obtain full benefit from your new cleaner. Keep this Instruction Manual in a handy place for future reference.

Important

Always switch the cleaner off and remove the plug from the electricity supply before cleaning your appliance, when not in use, or attempting any maintenance task. The cleaner must only be connected to an AC supply at the voltage shown on the rating plate. This cleaner should only be used for its intended purpose as described in these instructions.



1. Do not operate the steam cleaner too close to heaters, radiators or other hot surfaces.



2. Before inserting the plug into the wall, make sure your hands are dry.



3. When you want to remove the plug from the power socket, do not use the power cable, gently pull the plug from the power socket.



4. Exposure to hot steam can cause scalding





Safety Precautions & Warnings



IMPORTANT! Always switch off the wall outlet, cleaner, and remove the plug from the electricity power supply before cleaning your appliance, when not in use, or when attempting any maintenance task. The cleaner must only be connected to an AC power supply at the voltage shown on the rating label. This cleaner should only be used for its intended purpose as described in this instruction manual.

1. This appliance is not intended for use by persons (including children) with reduced physical, sensory or mental capabilities or lack of experience and knowledge, unless they have been given supervision or instruction concerning use of the appliance by a person responsible for their safety.
2. Always check the power cord before use, the power cord and the plug should be in a good condition and must not be damaged. If the power supply cord is damaged or defective, it must be replaced by the manufacturer, its service agent or similarly qualified persons in order to avoid a hazard.
3. Do not leave appliance unattended when plugged in. Switch off the wall outlet, and unplug the cleaner from the main power when not in use and before conducting maintenance, cleaning or troubleshooting.
4. To prevent electric shock, do not use outdoors. The steam cleaner is intended for household use only.
5. Children shall be supervised to ensure that they do not play with the appliance.
6. Use only as described in this manual. Use only manufacturer's recommended attachments.
7. Do not pull or carry by the power cord, do not use cord as a handle, do not close a door on the power cord or pull the power cord around sharp edges or corners.
8. Keep the power cord away from heated surfaces.
9. Do not point hot steam over the power cord.
10. Do not unplug by pulling on the power cord. To unplug, switch off the wall outlet, grasp the plug, not the power cord.
11. Do not handle plug or appliance with wet hands.
12. Do not use steam cleaner if it has been dropped, damaged, left outdoors or immersed into water. Return it to the nearest service centre.
13. Turn off all controls before unplugging.
14. The force and heat of the steam may damage certain materials. Some fabrics may react to the temperature of the steam. For example: unpainted wood or leather can be bleached by the action of steam; glossy plastic can be dulled by steam; acrylic fibre, velvet and linen react very sensitively to the temperature of steam.
15. Do not hold the steam in the direction of

- one spot for long periods! This can cause damage to materials!
16. Exposure to hot steam can cause scalding!
 17. Burns can occur from touching hot parts, hot water or steam. Use caution when draining the appliance after use as there may be hot water in the unit.
 18. The Safety Cap must not be open during use, ensure it is firmly sealed before commencing use.
 19. Always open the Safety Cap slowly when opening the water tank, this will allow any remaining steam to escape gradually.
 20. To reduce the risk of contact with hot water emitting from the steam nozzle, hold the nozzle away from the body and check for signs of condensation or leakage.
 21. Nozzle and attachments become hot during use. To avoid injuries, do not touch nozzle while using this appliance. Do not attempt to change attachments while unit is emitting steam.
 22. The hose may become hot during use. Use caution when handling to avoid burns or other injury.
 23. Never directly steam towards people, animals or plants.
 24. Never attempt to steam clean clothes which are still being worn.
 25. Do not handle or operate the steamer with wet hands and follow electrical safety precautions at all times.
 26. Ensure that the cleaner does not operate on an empty tank.
 27. Do not fill the steam water tank with more than 250mL of water. Submerging may result in a possible electric shock.
 28. Connecting the steam cleaner to improper voltage may result in damage to the steam cleaner and possible injury.
 29. Do not use steam cleaner if there are visible signs of damage or if it is leaking.
 30. Do not use on leather, wax polished furniture or floors, synthetic fabrics, velvet or other delicate, steam sensitive materials.
 31. Never put descaling, aromatic, alcoholic or detergent products into water tank, as this may damage it or make it unsafe for use.
 32. Only water should be used in this unit. Other cleaning agents will damage the unit and can cause injuries.
 33. Do not add cleaning solutions, scented perfumes, oils or any other chemicals to the water used in this appliance, as this may damage the unit or make it unsafe for use.
 34. Use tap water or distilled/purified water if the tap water in your area is very hard.
 35. Do not apply steam directly to very cold glass surfaces.
 36. The steam should not be aimed directly at parts containing electrical components such as the electrical components inside an oven.
 37. Damage caused by improper use of steam on objects, materials, persons and/or animals or by not observing the instructions in this manual will void the warranty.
- 

Warning: Danger of scalding. Please use with caution when using the hand steamer. The steam emitted from the hand steamer nozzle is very hot.
- 

CAUTION:
Surface may be hot. Avoid contact.

Instructions for Use

This product is intended for domestic use only.



Warning:

**danger of scalding. Please use caution when using the steam cleaner.
The steam emitted from this hand steamer is very hot!**



Attention:

- Water tank is under pressure.
- Remove the plug from the wall socket.
- Keep the trigger pressed to allow the steam to escape.
- Allow the device to cool down for 5 minutes before refilling.

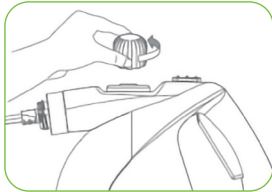

1. Remove the Safety Cap.
Turn the Safety Cap counterclockwise and remove it.



2. Check the Water Level.
If you have used the steamer before, check the water tank to make sure there is enough water.

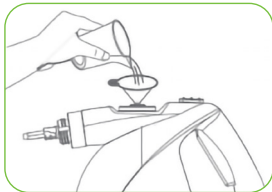

3. Add Water.
Use the provided measuring cup to pour 1 cup of water into the tank.

Instructions for Use (continued)



4. Secure the Safety Cap: replace the Safety Cap and turn it clockwise until it feels tight.

Note: Do not overtighten, as this may damage the screw threads.

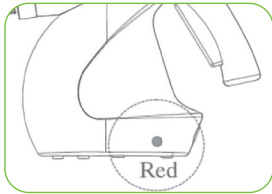

5. Connect to Power.
Plug the power cord into a nearby power outlet, preferably close to the area you want to clean.
6. Wait for Steam Readiness.
When the red indicator light is on, the steamer is heating up.

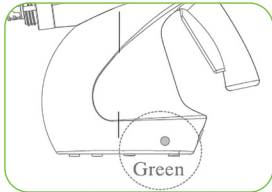

7. Once the green light appears, the steam is ready for use.

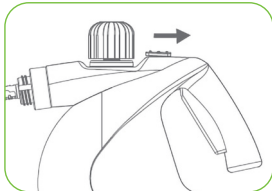

8. Unlock the Safety Lock.
Push the safety lock upwards to unlock.



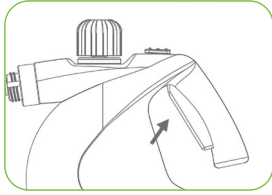

9. Release Steam.
Press down the steam button to release steam. It's designed for easy operation—no need to apply too much pressure with your thumb.

Maintenance

IMPORTANT! Always unplug the power plug from the power supply before performing any maintenance.

IMPORTANT! Tap water contains minerals that can build up in your steam. Regular cleaning of the boiler will restore the efficiency of your steam cleaner. We recommend that the cleaning is for every 3 months to enhance the performance of your steam cleaner.

WARNING! Allow the hand steamer to fully cool down before performing any maintenance or troubleshooting checks.



Warning: The water tank is under pressure. Follow these steps carefully to avoid injury.

1. Disconnect the power plug from the outlet.
2. Release Remaining Steam:
Set the safety lock to the press position, then press the steam switch to release any remaining steam from the tank.
3. Remove the Safety Cap:
While continuing to press the steam switch, push the safety lock and twist the Safety Cap counterclockwise to remove it.

Caution: Ensure all steam has been released before opening the Safety Cap to avoid burns.

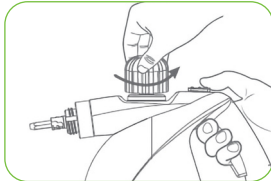

4. Wait 3–5 minutes before refilling the water tank.
This allows the steamer to cool down and prevents hot water from spraying out when adding new water.

Warning: Adding water too soon may cause burns or damage the device.

5. Add fresh water and thoroughly rinse out the boiler before use.



Attach Accessories

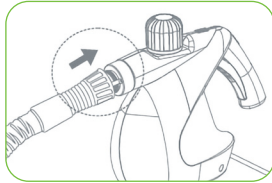

1. **Attach the Extension Connector.**
Install the extended connecting spray to the short spray nozzle on the steam cleaner. Make sure it is fully inserted to the end of the short nozzle.

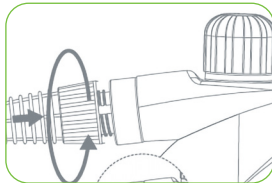

2. **Secure the Connection.**
Turn the connector clockwise to tighten. Ensure it is firmly assembled and there are no loose parts.

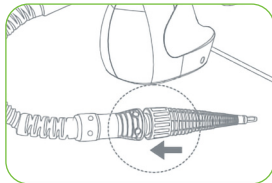

3. **Attach the Long Spray Nozzle.**
Connect the long spray nozzle to the other end of the extended connector.

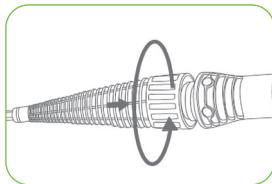

4. **Tighten the Long Nozzle.**
Turn the connection clockwise to secure the long nozzle. Again, check that the connection is tight and secure before use.

Troubleshooting

Problems and solutions

Please contact Godfreys Commercial Customer Support on 131 929 to find your local spare parts provider.

Fault	Solution
The steamer will not switch on.	<ul style="list-style-type: none">- Check the steamer is plugged in- Plug the steamer to different socket
The steamer will not produce the steam.	<ul style="list-style-type: none">- Check the water is enough in the clean water tank- Check the child-lock release is dis-engaged
Water leaks from the Safety Cap area of the hand steamer.	<ul style="list-style-type: none">- The Safety Cap seal could be damaged. Contact Godfreys Customer Care for further assistance.
The steamer leave too much water on the floor	<ul style="list-style-type: none">- Too much water is added to the boiler.



Spare Parts

Part	Part Number
Accessory Kit	32440611





1 Year Warranty

OPTIM All Rounder Hand Steamer



Your Optim All Rounder Hand Steamer, in the case of domestic use, has a one year warranty against product defects and failures when the product is used in accordance with the terms and conditions of this warranty statement.

This warranty is provided by Future Innovation Holdings Pty Ltd Trading as Godfreys Commercial ABN 98 677 632 021. This warranty commences from the original date of purchase and is not transferable. You are required to retain your original proof of purchase for any claims under this warranty. This warranty is valid only in the country where the cleaner is purchased.

Your Optim All Rounder Hand Steamer must be operated in accordance with these instructions and used only for domestic household cleaning to remove dirt from household. Your Optim All Rounder Hand Steamer is not fit to be used as a commercial cleaner, and is not designed for the cleaning of vitreous building material including particle board, construction products and similar products such as wood/ fibres, cement, fillers, fibre glass etc or excessive or frequent sand. The infrequent pick-up of these materials may be harmful to your cleaner and will void this warranty.

Refer to the instruction manual for further regarding the use and care of your Optim All Rounder Hand Steamer, as misuse or failure to follow the instructions voids this warranty.

In the event of service or advice being needed, or if you would like to make a claim under this warranty, please immediately stop using the Optim All Rounder Hand Steamer and contact Godfreys Commercial, 2 Drake Boulevard Altona, VIC 3018, or on 131 929, Monday-Friday 9am-5pm AEST or commercialsupport@godfreys.com.au.

The decision to repair or replace the cleaner is at the discretion of Godfreys Commercial depending on the circumstances and requirements of any applicable law. If Godfreys Commercial decide to repair or replace your Optim All Rounder Hand Steamer, it will do so at its

own cost. Any transportation costs involved in a claim under this warranty shall be borne by the claimant.

Godfreys Commercial is unable to accept responsibility under this warranty for any repair work not carried out by an authorised Service Agent, or any defect arising from or in connection with the use of non-genuine parts. If any part is no longer available or manufactured, Godfreys Commercial will replace it with a genuine functional replacement part. This warranty does not apply to the cost of replacing any parts of the Optim All Rounder Hand Steamer due to normal wear and tear, alterations, improper installation, physical abuse, misuse or accidental damage.

If proof of purchase cannot be provided at the time of a warranty claim or service, any work carried out on the Optim All Rounder Hand Steamer will be at claimant's cost.

The repair of the Optim All Rounder Hand Steamer under this warranty does not extend the original period of warranty. If your Optim All Rounder Hand Steamer is replaced under this warranty, the replacement will be covered by this warranty for the remainder of the original warranty period. However, you may still have statutory rights after this time.

The benefits conferred by this warranty are in addition to all other rights and remedies in respect of the product as outlined under the Competition and Consumer Act 2010 (Cth) and other State and Territory laws.

Our goods come with guarantees that cannot be excluded under the Australian Consumer Law. You are entitled to a replacement or refund for a major failure and compensation for any other reasonably foreseeable loss or damage. You are also entitled to have the goods repaired or replaced if the goods fail to be of acceptable quality and the failure does not amount to a major failure.