

Capsule *X*

User guide

You'll be up and running in no time.

CAP-02-ANZ

EXCLUSIVE TO
 **GODFREYS**
Commercial

 **Halo**TM

Before You Begin

This cleaner must be operated in accordance with these instructions and used only for domestic household cleaning. This cleaner is not fit to be used as an industrial cleaner and will void the manufacturer's warranty if used inappropriately.

Please read the manual before operating cleaner

This will ensure you obtain full benefit from your new cleaner. Keep this Instruction Manual in a convenient and safe place for future reference.

Important

Always switch the machine off and remove the plug from the electricity supply before cleaning your cleaner, when not in use, or attempting any maintenance task. This cleaner should only be used for its intended purpose as described in these instructions.

Precautionary measures:



1. Do not operate the vacuum cleaner too close to heaters, radiators or other hot surfaces.



2. Before inserting the power plug into the power supply, make sure your hands are dry.



3. Before turning on the vacuum cleaner, remove any large objects from the floor or cleaning surface in order to prevent damage to the filter.



4. When you want to pull the power plug from the power supply, do not use the power cable, gently pull the power plug from the power socket.



5. Do not use the vacuum cleaner to pick up water or liquids.

Safety Precautions & Warnings



IMPORTANT!

Always switch off the cleaner, when not in use or before attempting any maintenance task. The charger must only be connected to an AC power supply at the voltage shown on the rating label. This cleaner should only be used for its intended purpose as described in this instruction manual. Never operate the vacuum cleaner without filters. Read the manual attentively before using the cleaner for the first time.

When using your vacuum cleaner, basic precautions should always be observed, including the following;

1. This appliance is not intended for use by persons (including children) with reduced physical, sensory or mental capabilities or lack of experience and knowledge, unless they have been given supervision or instruction concerning use of the appliance by a person responsible for their safety.
2. Children should be supervised to ensure that they do not play with the appliance.
3. To prevent electrical shock, do not immerse the appliance, battery, or power plug into water or other liquids.
4. To prevent electrical shock, do not use the vacuum cleaner outdoors or on wet surfaces.
5. Always check the power cord before use, the power cord and the plug should be in a good condition and must not be damaged. If the power supply cord is damaged or defective, it must be replaced by the manufacturer, its service agent or similarly qualified persons in order to avoid a hazard.
6. The appliance and wall mount bracket are intended for domestic indoors use only.
7. Do not unplug by pulling on the power cord. To unplug, grasp the plug, not the power cord. Use only Australian and New Zealand electrical safety approved extension cords.
8. Avoid running the appliance over the power cable.
9. Do not handle or operate the appliance with wet hands and follow electrical safety precautions at all times.
10. Extreme caution should be exercised when using the appliance on stairs.
11. Do not attempt to change the attachments while the appliance is switched on. Use only manufacturer's recommended accessories.
12. Do not operate the vacuum cleaner too close to heaters, radiators and other hot surfaces.
13. Do not use the appliance to pick up flammable items or combustible liquids (i.e. gasoline, hot ashes, cigarettes, matches, explosive materials or anything burning) or use in areas where such substances and items may be present.
14. Do not use the appliance to pick up toxic materials (i.e. chlorine bleach, ammonia).
15. Never operate or use the appliance without the filters in place.

Safety Precautions & Warnings (continued)

16. Before vacuuming, remove any large or sharp objects from the floor or cleaning surface in order to prevent damage to the filter.
17. If the air inlet or floor head is blocked, switch off the cleaner straight away. Clear the blocked object before attempting to start the vacuum cleaner again.
18. Before carrying out any maintenance service or cleaning the filters, always switch off the vacuum cleaner.
19. Keep openings away from your face and body.
20. Do not use the vacuum cleaner if it is damaged or broken. If connection cables are damaged, have them replaced immediately.
21. Never clean the vacuum cleaner or any of the electrical parts, especially the electrical connections, with water or liquid cleaners.
22. Never attempt to make any modifications electrically to the vacuum cleaner and charging base.
23. Always store the appliance and charger indoors in a cool and dry place.
24. Do not pick up water, for dry household use only.
25. Use the electric motorised floor head only for vacuuming dust and dry substances in the home.
26. Never run over the power cable with the motorised floor head as this may cause damage to the power cable.
27. Never touch the roller brush while the vacuum cleaner is switched on.
28. To prevent unnecessary wear on the power head, keep it moving while in operation.
29. Damage caused by improper use or by not observing the instructions in this manual will void the warranty.
30. Ensure the wall outlet is switched off before unplugging the charger adaptor.

Battery use and care

1. The appliance is only to be used with the charger uniquely provided with the appliance.
2. Only use the specifically designated charger to charge the battery.
3. When appliance is not in use, keep it away from other metal objects, like paper clips, coins, keys, nails, screws or other small metal objects that can make a connection from one terminal to another. Shorting the appliance terminals together may cause burns or a fire.
4. Under abusive conditions, battery may catch fire and explode.
5. Do not charge or store the appliance outdoors or inside the car. Only charge or store the battery in a dry indoor area where the temperature is more than 5°C but less than 45°C. The charger is for indoor use only.
6. Never attempt to open the battery for any reason. If the plastic housing of the battery casing breaks or cracks, immediately discontinue use and do not recharge. Battery is not a serviceable part.
7. The charger is not a serviceable part.
8. Before disposal of your battery, fully discharge your battery by running the product until it stops.
9. The cleaner contains a Lithium Ion battery. Do not dispose of the appliance with your local garbage. Contact your local council for instructions on how to safely dispose of the battery.
10. Do not use the charger to charge a non-chargeable battery.

Welcome to CapsuleX

Thank you for choosing your Halo Capsule X cordless vacuum cleaner. We hope you will have many years of use from your Capsule X but before you begin please read this user guide completely.

For assistance, please reach out to Godfreys Commercial Customer Support & Service Hotline at **131 929**, or email us at **commercialsupport@godfreys.com.au**.



About Halo

After 20 years developing vacuum cleaners for big brands, in 2019 Paul Bagwell Founded Halo to take cordless vacuums in a different and better direction.

Innovation for the big household names seemed entirely focused on miniaturising old technology; but this was compromising performance, weight and efficiency. People were having to carry around heavy machines with very little capacity – the opposite of what they needed. Paul knew there was a better way of using cordless technology to deliver cordless cleaning without compromise.

Capsule X cracks the mould. Capsule X is lighter and hungrier.

Since launching in 2019 Halo Capsule has won numerous awards and accolades and been recognised as a game-changer. Now with Capsule X, Halo are raising the bar even higher: with extra power, extra capacity and the same amazing low weight.

Halo design and develop our unique and award-winning vacuums at our base in Leamington Spa, Warwickshire, England.



Best of British
Design

Patents Granted and Pending

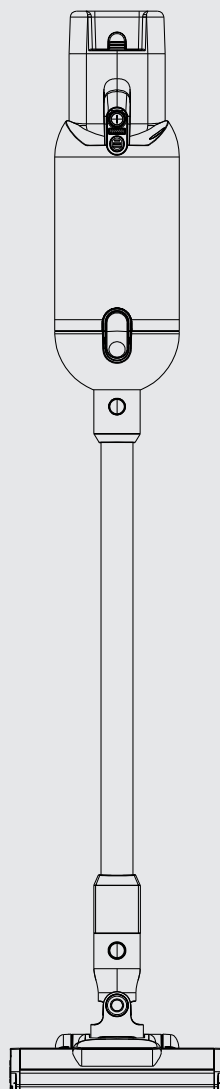

What's in the box

- 1 Capsule X Main Unit
- 2 Motor Brush Head (SKU: 33788293)
- 3 Crevice Tool (SKU: 31155815)
- 4 Brush and upholstery tool (SKU: 31155817)
- 5 Extension Tube (SKU: 31300878)
- 6 Charger (SKU: 33202431)
- 7 Dust Pouches (SKU: 32201959)
- 8 Accessory Clip (SKU: 31300880)
- 9 32V Battery (SKU: 33202430)
- 10 Wall Dock (SKU: 31300881)
- 11 Hard Floor Head (SKU: 33788297)
- 12 Stretch Hose (SKU: 31221089)
- 13 Mini Power Brush (SKU: 31155819)

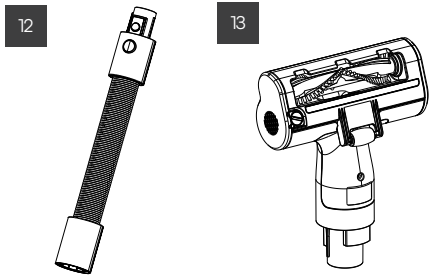
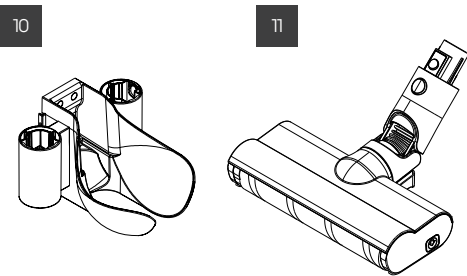
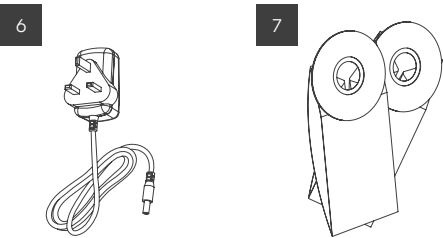
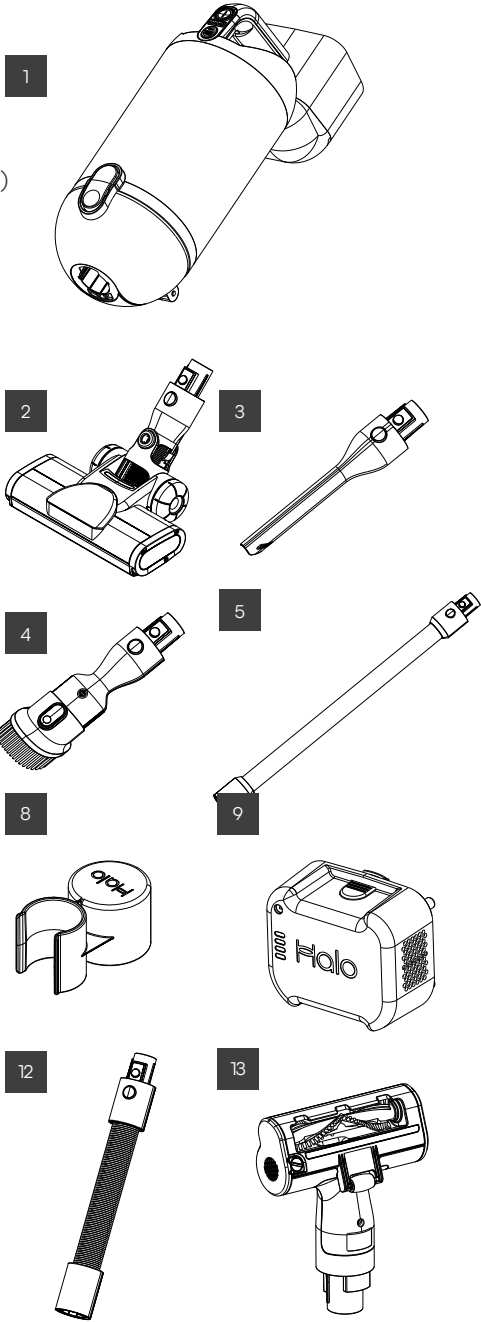

Getting started

Fitting the Dust Pouch

1. Open Capsule X by pressing latch A and opening the cover B. Always remove the Extension Tube and any accessories first.
 2. Simply drop the Dust Pouch into the cavity, with the circular card outermost.
 3. Check alignment and that the Dust Pouch card is sitting flat. Reclose.
- IF the cover does not close easily check Dust Pouch alignment.
Do not force closed.

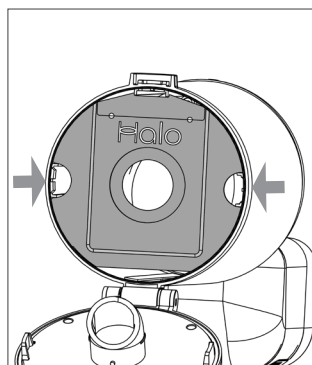
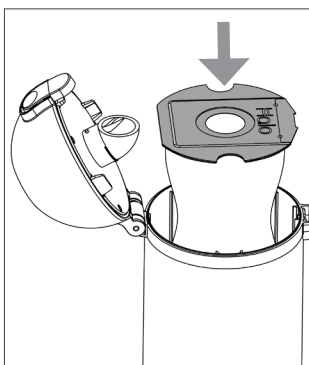
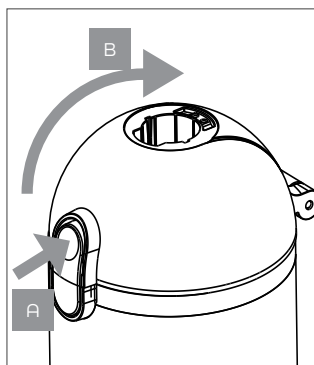

Fitting the Battery

4. Swing closed the cover B, if necessary pushing the latch at position C until an audible click is heard.
 1. Align Battery with rear of the Capsule X Main Unit, with the Halo logo upright.
 2. Push the Battery into place until a audible click is heard.
- Check Battery is secure both at the top and bottom before use.

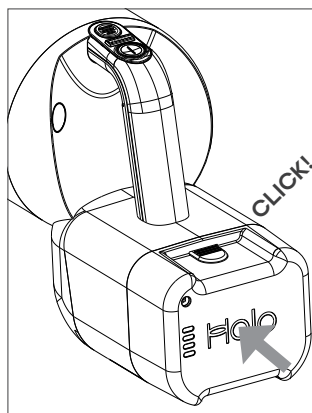
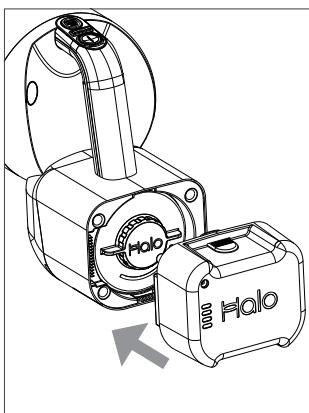
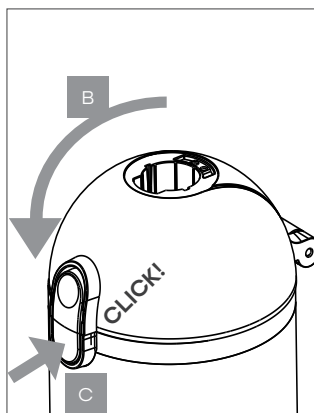

Installing the Wall Dock

1. The Wall Dock should be mounted using the fixings provided.

The Dock should be 100-105cm above the floor.

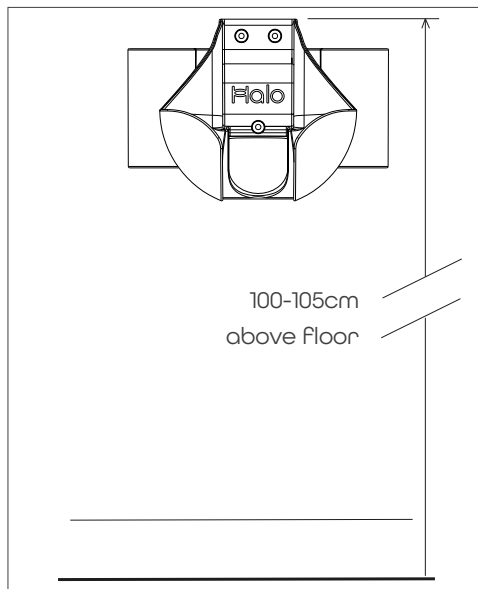

2. For convenience the charging cable can be attached for easy connection. The cable should be pushed into the grip features to secure.

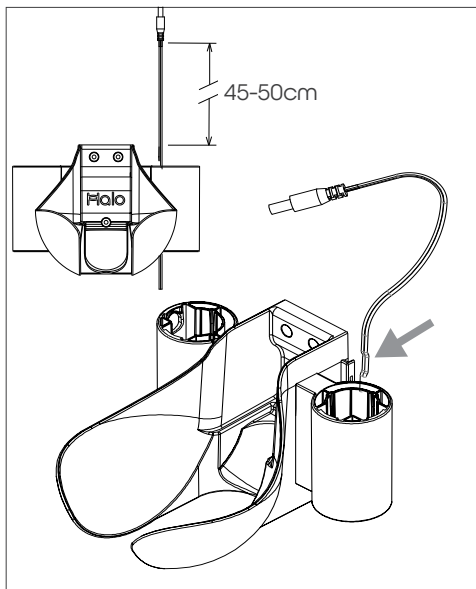

3. The Capsule X Vacuum and up to 4 accessories can then be held by the Wall Dock.

Ensure the Wall Dock is secure to the wall before use. Periodically check it has not become loose over time.

Capsule X **MUST** have the Extension Tube connected in order to be secure in the Wall Dock.

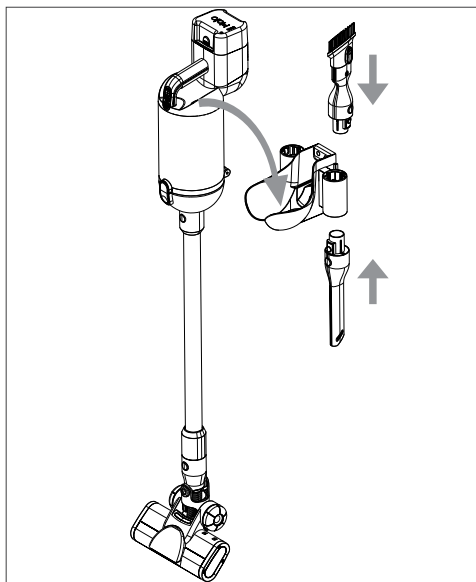

Charging

The charger connects between the Capsule X Battery and the mains.

The Battery can be charged while it is connected to Capsule X or when separated.

The Battery can not be charged when Capsule X is in use.

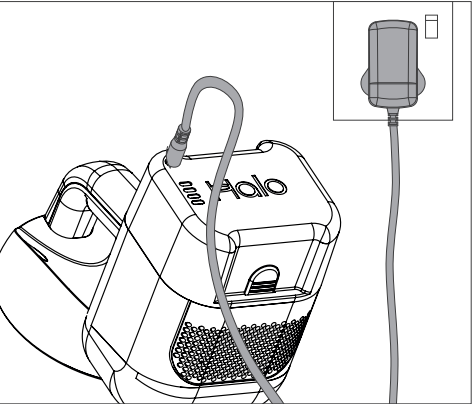

Runtime indicator

The Battery indicator will show fewer bars lit as Capsule X is used.

The last bar will flash red shortly before the Battery is exhausted.

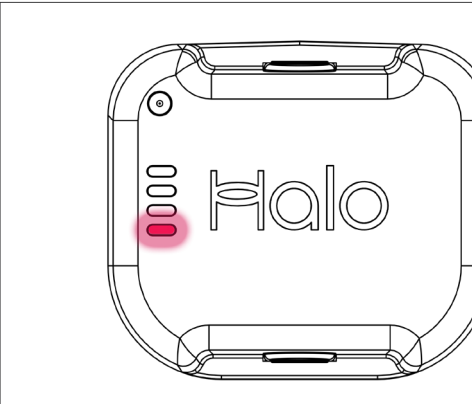

Charging Status

Whilst charging, the Battery indicator will show the level of charge from 0-100% in 25% increments.

Capsule X can be left connected when fully charged. The charger will enter sleep mode and no electricity will be consumed.

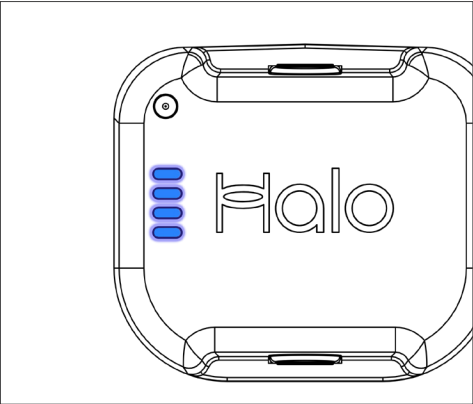

Runtime hints and tips

For full runtime Capsule X should be charged for 2 hours from empty and cool. Allow an extra 30 mins if the battery is very warm.

Capsule X's onboard computer estimates charge level and may show Full prior to this time. Charge for the full 2.5 hours.

Runtime Guide

Eco Mode	Over 60 minutes
Performance Mode	Over 25 minutes
Boost	Approx 9 minutes

Figures are estimates based on in home testing. Results in different homes may vary with different ambient temperatures and flooring types.

Additional batteries to provide extra runtime are available from Halo.

Attaching the accessories

The accessories can be attached in a variety of ways

1. The Motor Brush Head or any of the accessories can be attached to the end of the Extension Tube.
2. Alternatively any of the accessories can be connected directly into the Capsule X Main Unit to allow handheld operation.

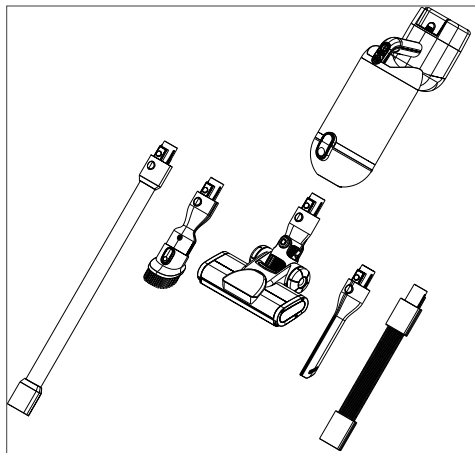
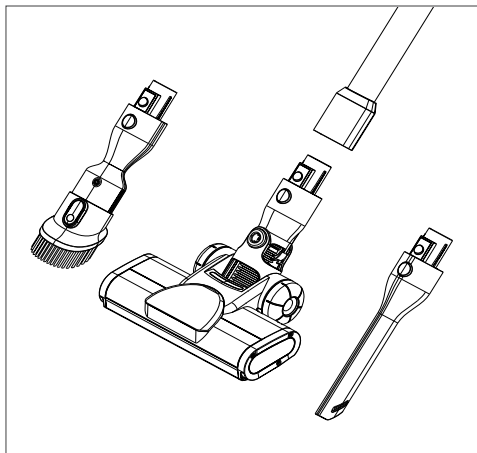

3. Release accessories by depressing the release button (A) then pulling them away from the Main Unit (B).

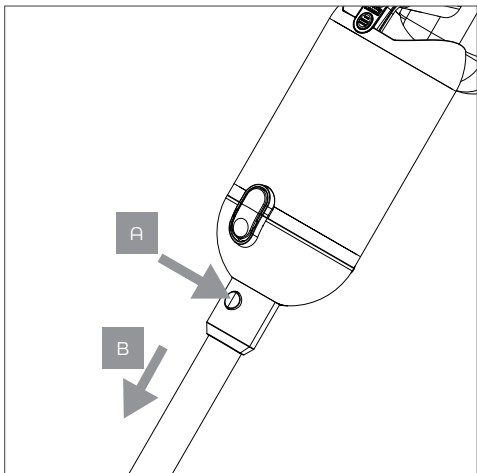

Accessory Clip

4. The accessory clip can be fitted to the top of the Extension Tube. Simply push the clip onto the tube then insert the chosen accessory. This can then be carried with your Capsule X.

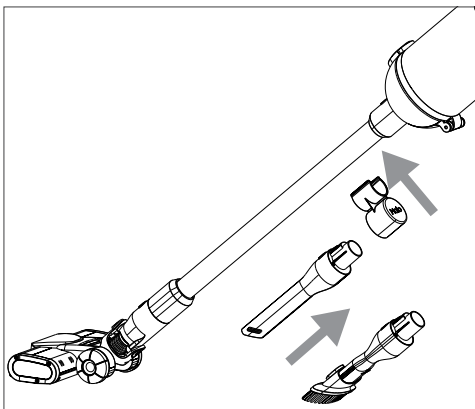

Attaching the accessories (continued)

Reclining to Clean

Simply recline Capsule X while keeping one foot on the Motor Brush Head. There will be an audible click. This is normal.

Capsule X is ready to Clean

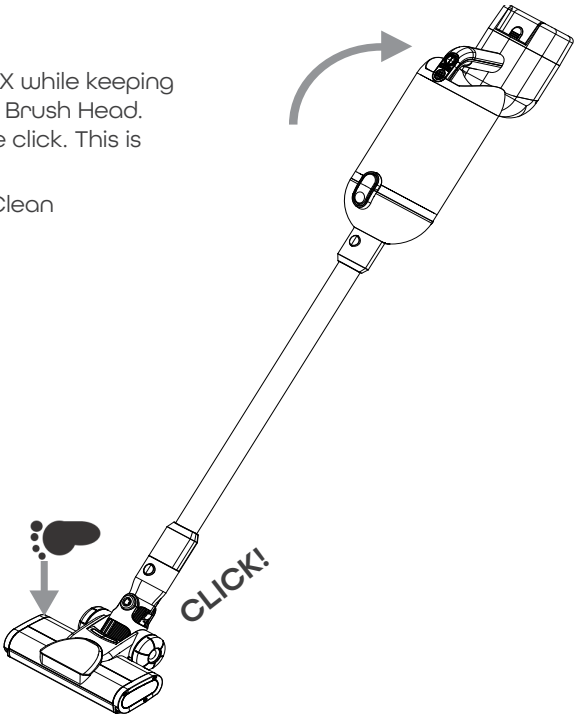

Powering up

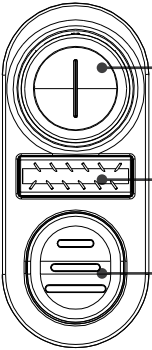

- 1 Main on/off**
Starts Capsule X.
Capsule X always starts in Performance mode.
 - 2 Motor Brush Head on/off**
Starts the Motor Brush Head or Hard Floor Head if Fitted
For best results on carpets and rugs it is recommended to have the brush rotating when cleaning.
 - 3 Power Volume Button**
Press to cycle between Eco, Performance and Boost mode.
- | | | |
|---|---|--|
| ≡ Eco
For longest runtime and great cleaning. | ≡ Performance
For powerful cleaning on carpet and hardfloor | ≡ Boost
Available For short periods where maximum performance is required. |
|---|---|--|

Cleaning Tips

Motor Brush Head

Press the Motor Brush button to start the brushes turning. A green light will appear while in operation.

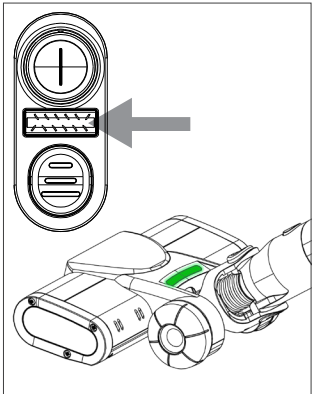

Brush usage

The Motor Brush Head can be used for cleaning carpets and rugs. The brush should be switched off for hard floor surfaces.*

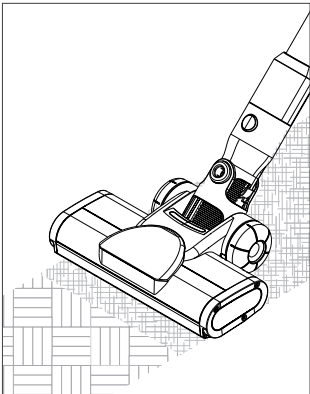

Cleaning Stairs

For stability and convenience the Motor Brush Head or Mini Power Brush can be connected directly to the Capsule X main unit.

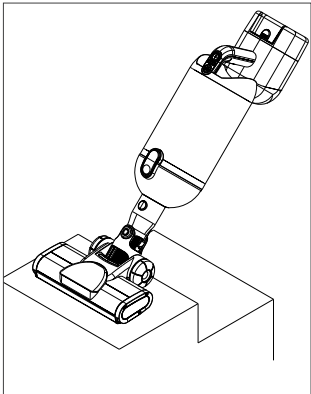

***Note:** For the very best cleaning performance on Hard Floor Halo recommend using the available Hard Floor Head.

Removing the Battery

1. Press top and bottom Battery release buttons (A and B) together.
2. Withdraw Battery From Capsule X main unit.

The Battery can be charged whilst removed.

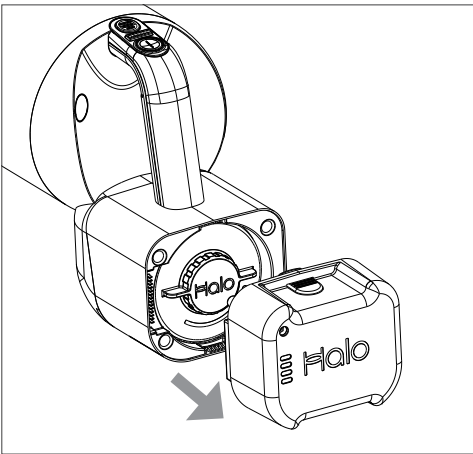
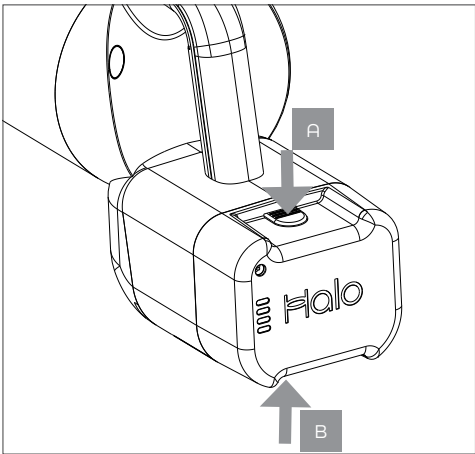

Holding and Carrying

Capsule X Equilibrium Engineering

Halo Capsule X is designed to be perfectly balanced in use for easier handling and the feeling of ultimate lightweight.

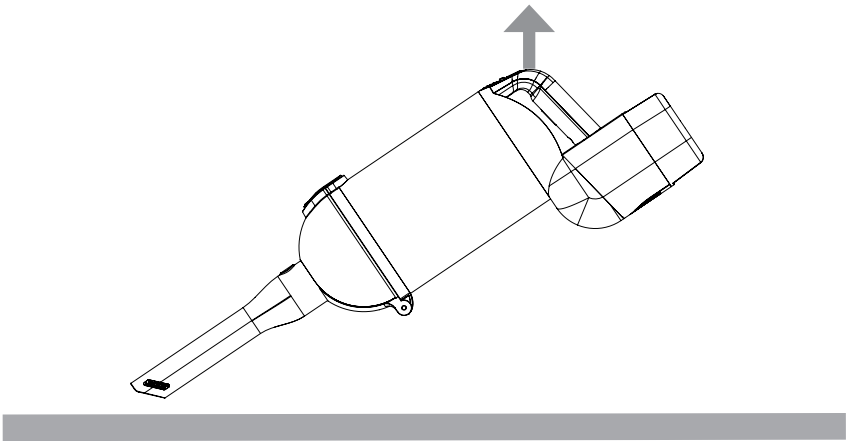

For convenience when moving Capsule X it can be carried by the main handle.

Carry the Capsule X up stairs by holding it on the Extension Tube just below the Main Unit. This leaves the other hand free to hold the handrail.

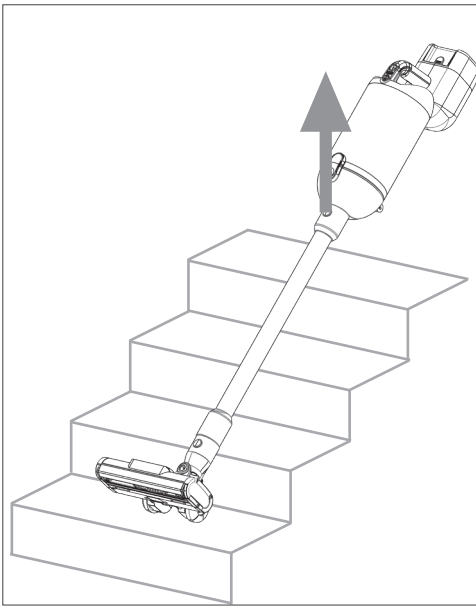
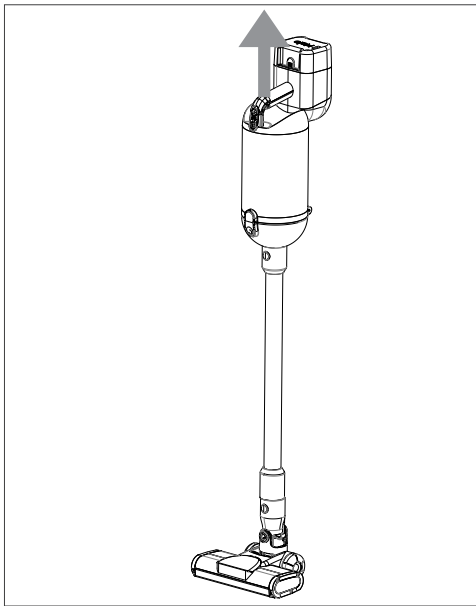

Changing the Dust Pouch

Dust Pouch indicator

When the Dust Pouch is Full and Capsule X is running in Boost mode the indicator will constantly light red.

To maximise dirt capacity Halo recommend occasionally gently shaking the Capsule X Main Unit between uses to evenly distribute the dirt in the dust pouch.

Use Boost mode periodically to check the indicator. The light is an indicator only and Halo recommend intermittent visual checks inside the dust pouch.

1. Remove the Extension Tube and any accessories.

Open Capsule X by pressing the latch A, then swinging open the cover B.

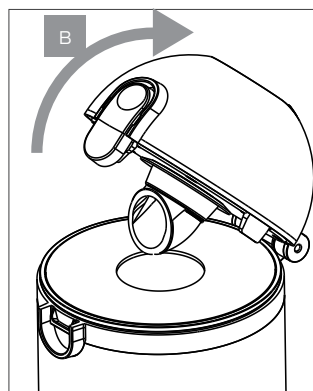
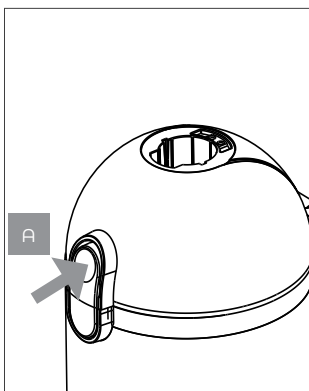
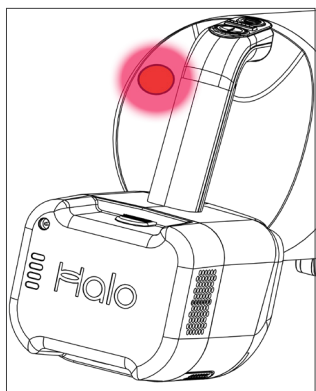

2. Lift the Dust Pouch clear or let it drop under its own weight. Always dispose of Dust Pouches responsibly.

3. Simply drop the new Dust Pouch into the cavity, with the circular card outermost. .

4. Check alignment and that the Dust Pouch card is sitting flat. Reclose.
If the cover does not close easily check Dust Pouch alignment.
Do not Force closed.

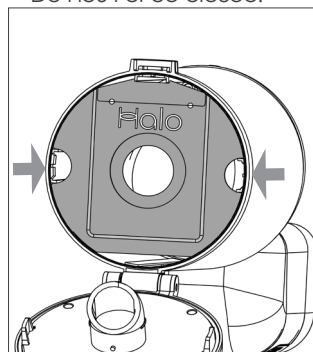
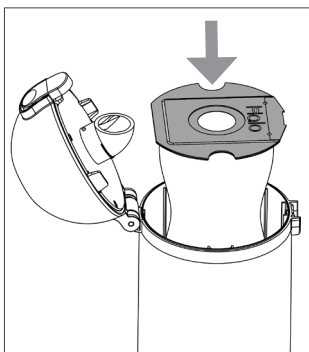
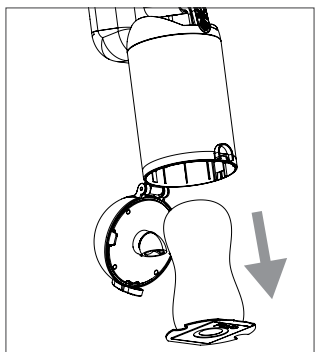

Maintenance

Capsule X is designed to be as free from maintenance as possible, but the following can help keep your Capsule X in top condition.

Blockages

All vacuums block from time to time. With Capsule X most blockages can be fixed by simply changing the Dust Pouch and using Boost mode to suck through any blockages.

In the event this is unsuccessful check the Extension Tube and Motor Brush Head for remaining blockages and remove these by hand. The use of sharp tools may damage Capsule X and invalidate the warranty.

Motor Brush Head

Periodically, hair can become wrapped around the brush roll and should be removed to maintain peak performance.

1. Remove the Motor Brush Head from both the Capsule X unit and the Extension Tube in order to isolate it from any power source.
2. Unlock the endcap (A) by turning it anticlockwise.
3. Turn until the brush can be withdrawn
4. The brush roll can then be completely removed.
5. Hair can be trimmed clear with a pair of scissors.
6. Ensure all parts are clear of hair and obstructions. Parts should reassemble without being forced.
7. Reinsert brush roll and turn endcap clockwise to secure.

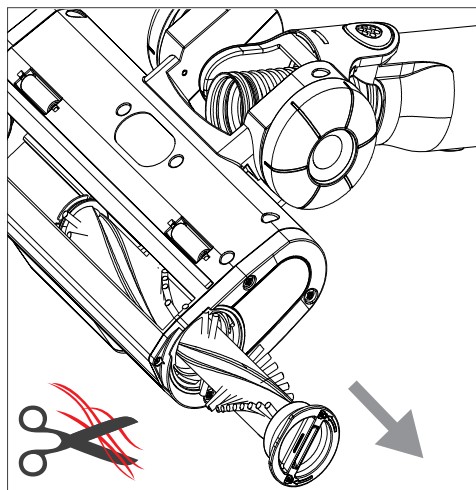
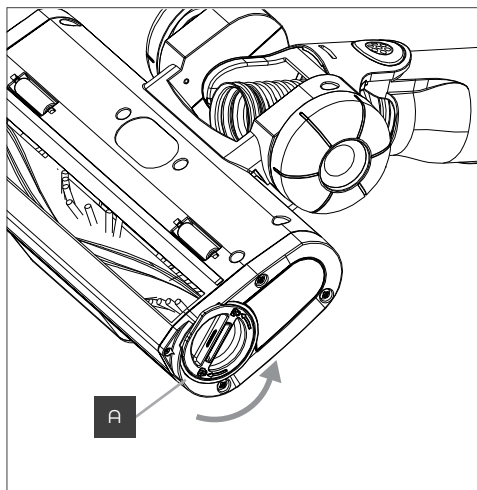

Hard Floor Head

Should items become trapped around the roller the roller can be removed.

1. Depress the button (A) then rotate the end cap clockwise (B).
2. The roller can then be withdrawn.

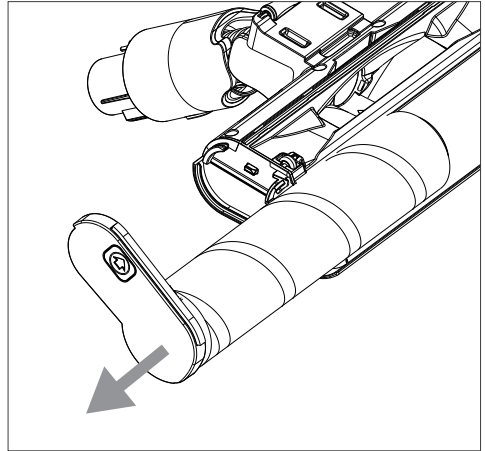
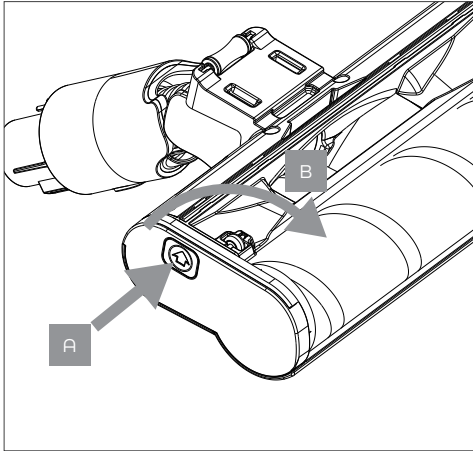

Mini Power Brush

To maintain peak performance periodically remove hair from the brush.

1. Use a small coin or screwdriver to unlock the Fastener anticlockwise (A) rotate the end cap anticlockwise (B).
2. The mini brush can then be withdrawn. Hair can be trimmed clear with a pair of scissors.

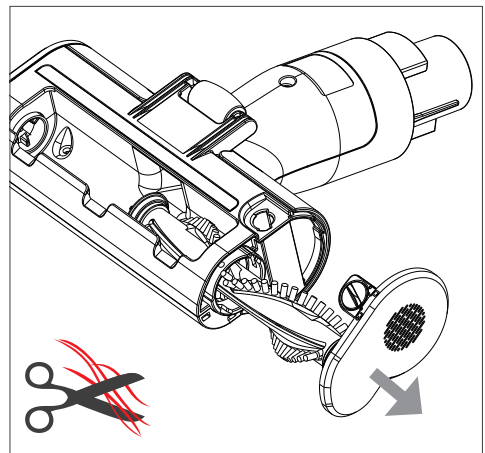
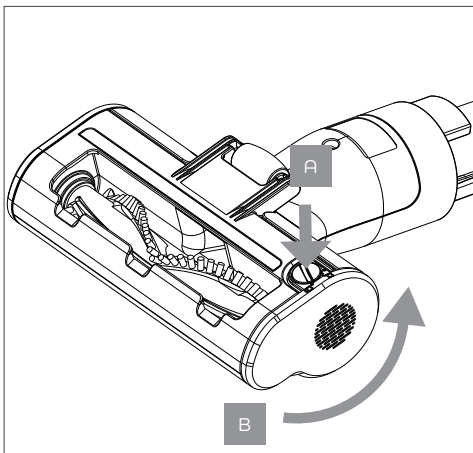

Maintenance (continued)

Dust Pouch Filter

After sustained periods of heavy use or if the Dust Pouch has become damaged then the Dust Pouch Filter may need to be cleaned or replaced.

Once the Dust Pouch has been removed the Filter can be pulled out of the pouch chamber using the tab shown.

The Filter can be rinsed thoroughly under a tap and then dried for 24 hours before being replaced.

Use of a wet Filter will invalidate the warranty. Never use Capsule X without the Filter fitted.

Always ensure tab is positioned outward when replacing the Filter.

Once refitted check the Filter is secure, fitted all the way around its diameter and that it does not drop out under its own weight.

Halo recommend cleaning or replacing the Dust Pouch Filter every 6 months or when it becomes visibly dirty.

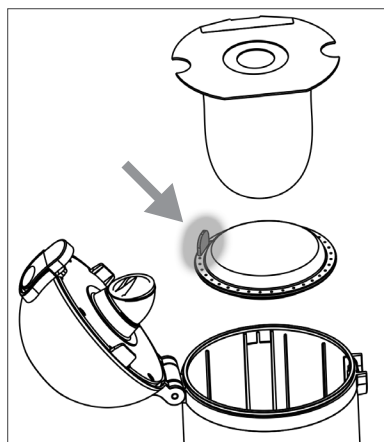

Exhaust Filter

After sustained periods of heavy use or if the Dust Pouch and/or Dust Pouch Filter have become damaged then the Exhaust Filter may need to be replaced. The Filter is not washable and should be replaced completely at the end of its life.

Halo recommend replacement of the exhaust Filter every 2 years.

IF required replacement Filters can be purchased from capsuleclean.com/spares

1. Remove the Battery (see page 10) and turn the Filter anticlockwise to unlock.

2. Pull the Filter clear.

To refit turn clockwise until horizontal.

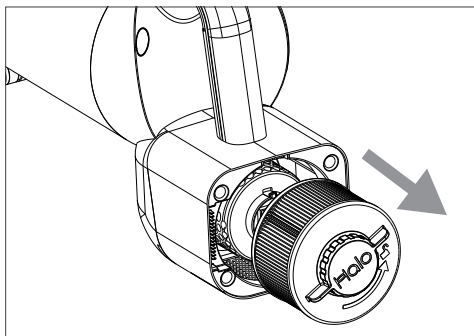
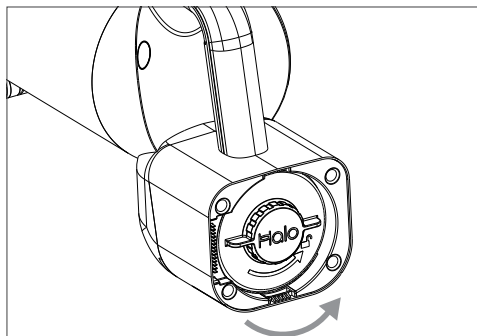

Troubleshooting

Capsule X is not cleaning well	<ol style="list-style-type: none"> 1. Change the Dust Pouch. 2. Check For blockages. 3. Remove hair from the Motor Brush Head.
Capsule X won't switch on	<ol style="list-style-type: none"> 1. Charge the Battery For at least 2.5 hours 2. Change the Dust Pouch and check For blockages. 3. Let Capsule X cool For 30 minutes and try again.
Dirt is Falling back out of the Motor Brush head	<ol style="list-style-type: none"> 1. Change the Dust Pouch 2. Check For blockages
Motor Brush Head light turns red/orange	<ol style="list-style-type: none"> 1. Remove the brushes. ensure there is nothing tangled around them. 2. Inspect the Motor Brush case and piping for any blockages or damage. 3. Power up the Floor tool without the brushes inserted and check For Function. 4. Reinsert the brushes, ensuring they click back in fully.
Battery not lasting	<ol style="list-style-type: none"> 1. Leave the charger connected For at least 2.5 hours 2. Check the correct Halo charger is being used.
<p>If the above does not work please email GodFREYS Commercial at commercialsupport@godfreys.com.au where we will be happy to help.</p>	

Indicator lights

In the event of a problem Capsule X has a handful of helpful feedback lights.

Red light on Motor Brush Head

Brush is jammed

1. Disconnect the Motor Brush Head from the Extension Tube and main body to isolate it from power.
2. Check for blockages.

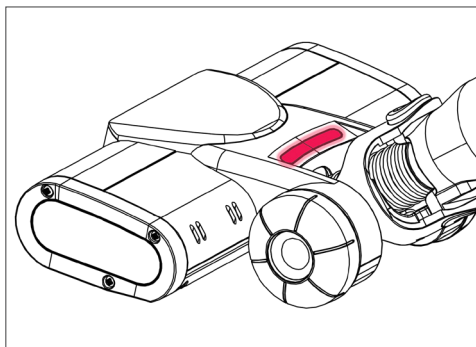

2 lights flashing on Battery

Battery is hot

1. Battery will not function until cool.
2. Cooling will take approximately 30 minutes at room temperature.
3. Normal function will then resume.

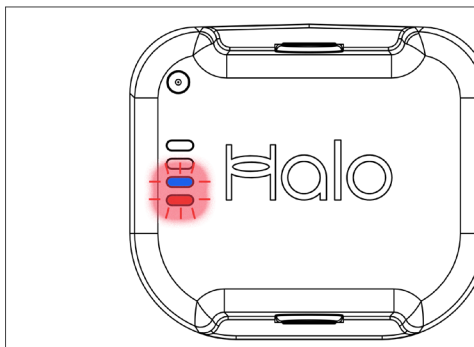

Dust Pouch indicator Flashing

Capsule X main unit is hot!

Stop using Capsule X.

2. Check for blockages.
3. Change the Dust Pouch and charge the Battery.
4. Allow Capsule X to cool for at least 30 minutes.

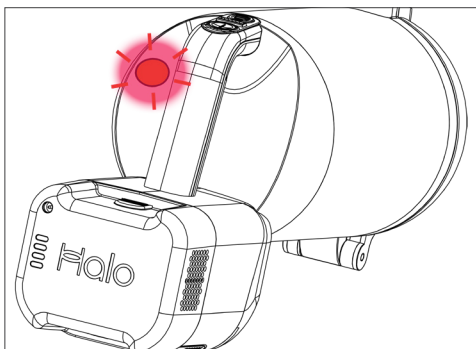

4 lights flashing on Battery

Battery removed whilst in use OR Capsule X motor is jammed

1. Remove then reattach the Battery.
2. Check Filter and Dust Pouch are in place.
3. Fully charge the Battery.
4. If problem persists contact Halo support hello@capsuleclean.co.uk

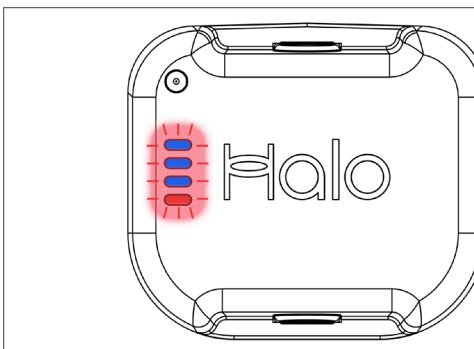

Capsule X technical specification

Voltage	32V
Max Power	400W including 70W power brush motor
Battery capacity	57.6Wh
Charge time	2 hrs (cool battery) 2.5hrs (hot battery)
Charger	34.2V DC 1A
Weight	2.6Kg

Spare Parts

Product Code	Description
33788293	Motor Brush Head
31155815	Crevice Tool
31155817	Brush and upholstery tool
31300878	Extension Tube 611mm
33202431	Charger
32201959	Dust Pouches
31300880	Accessory Clip
33202430	32V Battery
31300881	Wall Dock
33788297	Hard Floor Roller
31221089	Stretch Hose
31155819	Mini Power Brush
32201957	Exhaust Filter
33788294	Motor Brush Head Replacement Roller with End Cap
32201958	Pre Filter
33301081	Motor

Warranty

Your Halo Stick Vacuum, in the case of domestic use, has a two* years warranty against product defects and failures when the product is used in accordance with the terms and conditions of this warranty statement.

This warranty is provided by Future Innovation Holdings Pty Ltd Trading as GodFREYS Commercial ABN 98 677 632 021. This warranty commences from the original date of purchase and is not transferable. You are required to retain your original proof of purchase for any claims under this warranty. This warranty is valid only in the country where the cleaner is purchased.

Your Halo Stick Vacuum must be operated in accordance with these instructions and used only for domestic household cleaning to remove dry dirt and dust from household carpets, flooring and fabrics. Your Halo Stick Vacuum is not fit to be used as an industrial cleaner, and is not designed for the collection of vitreous building material including particle board, construction products and similar products such as wood/ fibres, cement, fillers, fibre glass etc or excessive or frequent sand. The infrequent pick-up of these materials may be harmful to your cleaner and will void this warranty.

Accessories and consumables including dust bags and filters, unless defective in manufacture, are not subject to this warranty. In order to prolong the life of accessories and consumables, regular care and maintenance is recommended.

Refer to the instruction manual for further regarding the use and care of your Halo Stick Vacuum, as misuse or failure to follow the instructions voids this warranty.

In the event of service or advice being needed, or if you would like to make a claim under this warranty, please immediately stop using the Halo Stick Vacuum and contact GodFREYS Commercial, 2 Drake Boulevard Albion, VIC 3018, or on 131 929, Monday-Friday 9am-5pm AEST or commercialsupport@godFREYS.com.au.

The decision to repair or replace the cleaner is at the discretion of GodFREYS Commercial depending on the circumstances and requirements of any applicable law. If GodFREYS Commercial decide to repair or replace your Halo Stick Vacuum, it will do so at its own cost. Any transportation costs involved in a claim under this warranty shall be borne by the claimant.

GodFREYS Commercial is unable to accept responsibility under this warranty for any repair work not carried out by an authorised Service Agent, or any defect arising from or in connection with the use of non-genuine parts. If any part is no longer available or manufactured, GodFREYS Commercial will replace it with a genuine functional replacement part. This warranty does not apply to the cost of replacing any parts of the Halo Stick Vacuum due to normal wear and tear, alterations, improper installation, physical abuse, misuse or accidental damage.

If proof of purchase cannot be provided at the time of a warranty claim or service, any work carried out on the Halo Stick Vacuum will be at claimant's cost.

The repair of the Halo Stick Vacuum under this warranty does not extend the original period of warranty. If your Halo Stick Vacuum is replaced under this warranty, the replacement will be covered by this warranty for the remainder of the original warranty period. However, you may still have statutory rights after this time.

The benefits conferred by this warranty are in addition to all other rights and remedies in respect of the product as outlined under the Competition and Consumer Act 2010 (Cth) and other State and Territory laws.

Our goods come with guarantees that cannot be excluded under the Australian Consumer Law. You are entitled to a replacement or refund for a major failure and compensation for any other reasonably foreseeable loss or damage. You are also entitled to have the goods repaired or replaced if the goods fail to be of acceptable quality and the failure does not amount to a major failure.

*Two year warranty on parts and labour excluding the battery which has a one year warranty.



Halo Appliances Ltd.
Warwickshire, England

Customer Support & Service Hotline

131 929

commercialsupport@godfreys.com.au

Distributed in Australia by Godfreys Commercial
2 Drake Boulevard Altona, VIC 3018, Australia.

EXCLUSIVE TO

